

INDOOR Product Spec.

Model	C1.0-I	C1.37-I	C1.66-I	C1.86-I	C2.0-I	C2.5-I	C3-I	C4-I
Pixel Pitch	1.0mm	1.379mm	1.666mm	1.860mm	2mm	2.5mm	3mm	4mm
LED Configuration	SMD0808	SMD1010	SMD1010	SMD1515	SMD1515	SMD2020	SMD2020	SMD2020
Pixel Density(m2)	100000Dots/m ²	525625Dots/m ²	360000Dots/m ²	288906Dots/m ²	250000Dots/m ²	160000Dots/m ²	105625Dots/m ²	62500Dots/m ²
Lamp Board Dimensions (mm)	320*160*14.5mm							
Module Resolution	320*320	232*232	192*192	172*172	160*160	128*128	104*104	80*80
Scanning Mode	1/40	1/29	1/32	1/43	1/20	1/32	1/26	1/20
Brightness(cd/m2)	≥450cd/m ²	≥450cd/m ²	≥450cd/m ²	≥450cd/m ²	≥450cd/m ²	≥450cd/m ²	≥600cd/m ²	≥450cd/m ²
Gray Scale(bit)	14-16bits							
Refresh Rate(HZ)	3840Hz							
PowerConsumption (Max W/m2)	≤580W/m ²	≤580W/m ²	≤580W/m ²	≤439W/m ²	≤439W/m ²	≤457W/m ²	≤413W/m ²	≤465W/m ²
Cabinet Size	320*320*45mm							
Cabinet Weight(kg/pcs)	2.45kg							
Curved Angle(°)	0°							
Viewing Angle(H/V)	140°/140°							
IP Rating (Front/Rear)	IP30							
Maintenance Mode	Front or Rear							
Installation Mode	Hanging and Stacking							
Input Voltage(V)	100-240V~50/60Hz							
Temperature Range°C	Operation:-10°C~+40°C							
Operating Humidity	10-90% RH							
Service Life	100000H							

OUTDOOR Product Spec.

Model	C2.5-O	C3-O	C4-O	C5-O	C6-O	C8-O	C10-O
Pixel Pitch	2.5mm	3.076mm	4mm	5mm	6.66mm	8mm	10mm
LED Configuration	SMD1515	SMD1515	SMD2525	SMD2525	SMD2525	SMD3535	SMD3535
Pixel Density(m2)	160000Dots/m ²	105625Dots/m ²	62500Dots/m ²	40000Dots/m ²	22500Dots/m ²	15625Dots/m ²	10000Dots/m ²
Lamp Board Dimensions (mm)	320*160*14.5mm						
Module Resolution	128*128	104*104	80*80	64*64	48*48	40*40	32*32
Scanning Mode	1/16	1/13	1/10	1/8	1/6	1/5	1/2
Brightness(cd/m2)	≥3500cd/m ²	≥4000cd/m ²	≥5000cd/m ²	≥4500cd/m ²	≥4500cd/m ²	≥4500cd/m ²	≥5500cd/m ²
Gray Scale(bit)	14-16bits						
Refresh Rate(HZ)	3840Hz						
PowerConsumption (Max W/m2)	≤648W/m ²	≤786W/m ²	≤909W/m ²	≤836W/m ²	≤892W/m ²	≤866W/m ²	≤857W/m ²
Cabinet Size	320*320*45mm						
Cabinet Weight(kg/pcs)	2.45kg						
Curved Angle(°)	0°						
Viewing Angle(H/V)	140°/140°						
IP Rating (Front/Rear)	IP66						
Maintenance Mode	Front or Rear						
Installation Mode	Hanging and Stacking						
Input Voltage(V)	100-240V~50/60Hz						
Temperature Range°C	Operation:-10°C~+40°C						
Operating Humidity	10-90% RH						
Service Life	100000H						

Bracket Spec.

Model Name	DIY-1X1
Weight(kg/pcs)	0.467KG
Dimensions	320*320*16mm

Photos

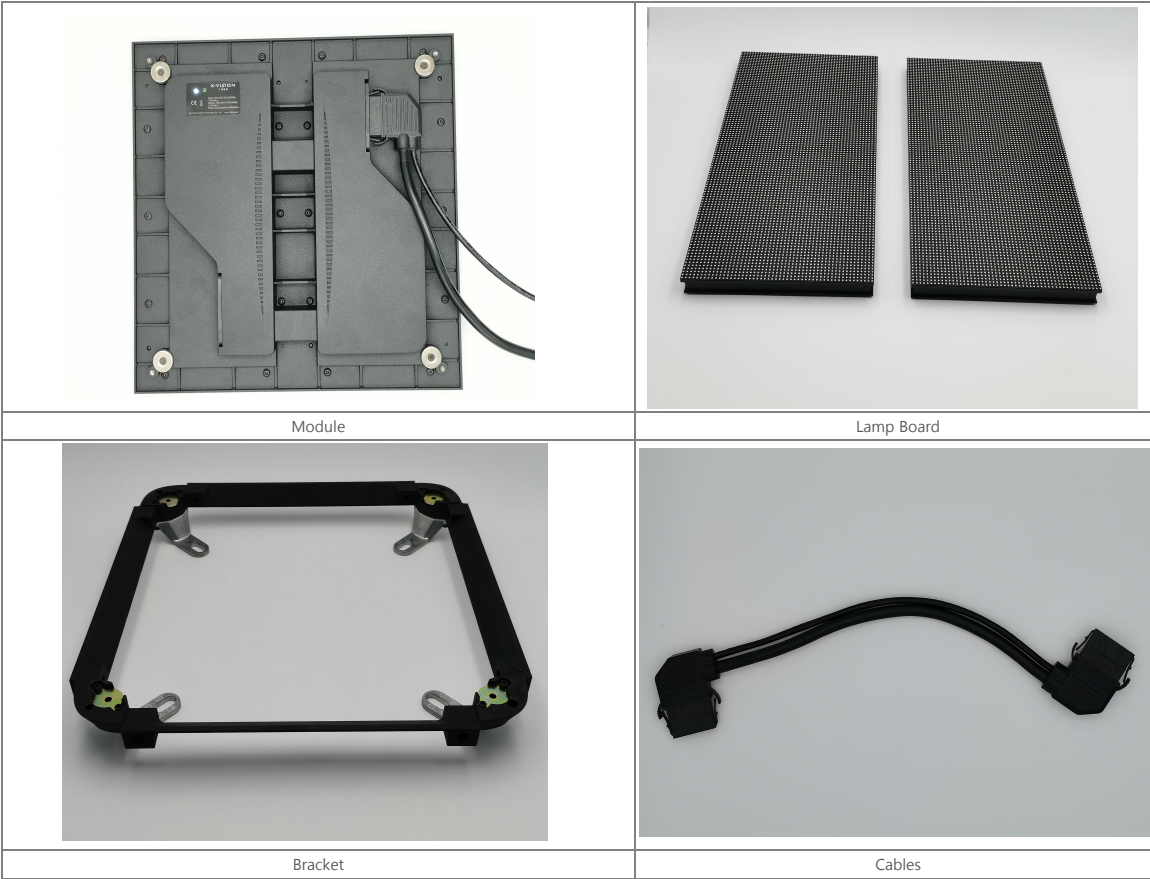

System (Novastar)

Model	TB3	TB6	TB8
Loading Capacity	650,000	1,300,000	2,300,000
Dual Wi-Fi (AP/Station)	√	√	√
Async Display	√	√	√
Phone Control	√	√	√
Cloud Service	√	√	√
Redundancy	√	√	√
4G	√	√	√
Lora module (for ...)	√	√	√
HDMI & LOOP	x	√	√
Limitation of width or height	W: 4096	W: 4096	W: 4096
	H:1920	H:1920	H:1920



Case Study



千林商店街, Osaka, Japan (P4 Outdoor, 1600cm X 960cm)



Others