



## Floor LED Display Specifications

---



### **FEATURES:**

- Cost-effective for fixed installation
- Up to 3000kg/m<sup>2</sup> load bearing capacity
- Customizable heights of screen
- Anti-slip, anti-glare, anti-UV, anti-friction
- Front(up-side) maintenance
- Front IP54

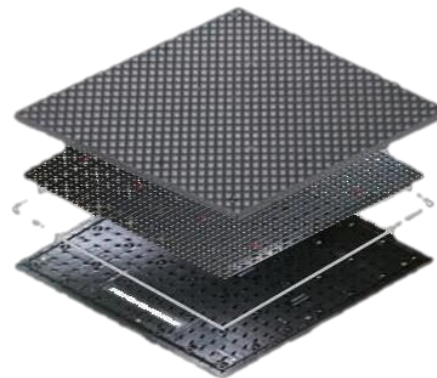

Note: Product specifications subject to change without notice.

All rights reserved by LA Visual.

[www.lavisual.cn](http://www.lavisual.cn)



## Floor LED Display Specifications

|                       |                                    |
|-----------------------|------------------------------------|
| Pixel Pitch (mm)      | 2.9mm, 3.9mm, 4.8mm, 5.2mm, 6.25mm |
| Module Size (mm)      | 250*250mm                          |
| Cabinet Size (mm)     | 500*500/500*1000                   |
| Brightness (cd/m2)    | 1000~1500cd/m2                     |
| Refresh Rate (Hz)     | 1920/3840Hz                        |
| Maintenance           | Front                              |
| IP Rating             | IP54 front                         |
| Weight                | 55kg/m2                            |
| Drive Type            | Constant Current Driving           |
| Input Voltage         | AC 110V~240V                       |
| Power Consumption     | Vary to pixel pitch                |
| Operating Temperature | -20℃ to 65℃                        |
| Storage Temperature   | -35℃ to 85℃                        |
| Operating Humidity    | 10% to 90%                         |
| Storage Humidity      | 5% to 90%                          |

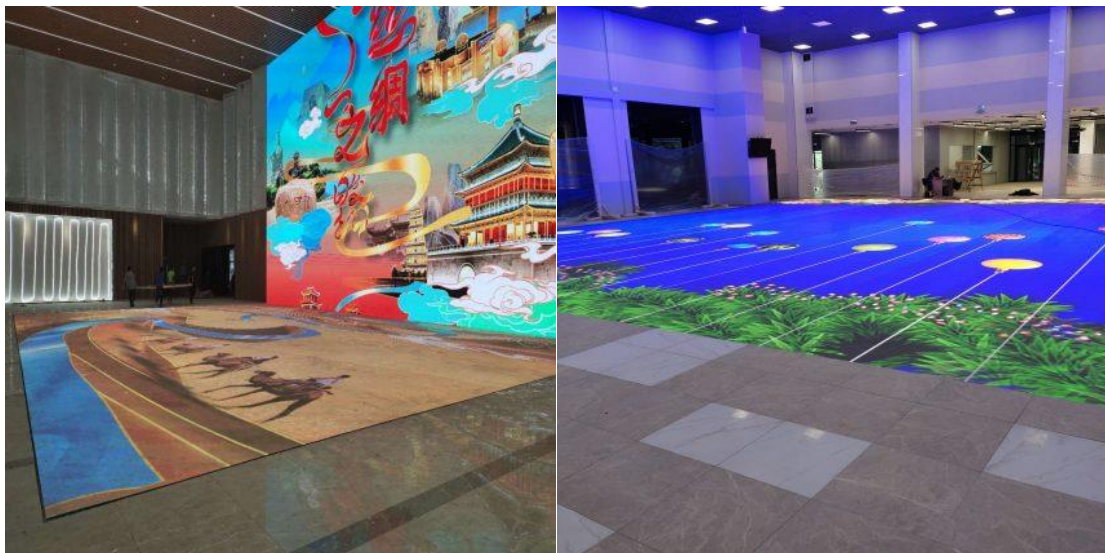

Note: Product specifications subject to change without notice.

All rights reserved by LA Visual.

[www.lavisual.cn](http://www.lavisual.cn)